

USER MANUAL QUICK INSTALLATION GUIDE PGR42R



WIRED REMOTE CONTROL
Compatible with PGR45B



USER MANUAL QUICK INSTALLATION GUIDE PGR42R WIRED REMOTE CONTROL



Planet Audio
3451 Lunar Court • Oxnard, CA 93030
www.planetaudiousa.com
888-990-1236 US Toll-free
805-751-4854 Customer Service
tech support: www.planetaudiousa.com/customer-support



Copyright © 2017
PRINTED IN CHINA

Thank you for purchasing this
Planet Audio®

PGR42R Wired Remote Control
Please read through these instructions carefully so you will know how to operate your model properly. After you have finished reading the instructions, keep this document in a safe place for future reference.

THIS PACKAGE CONTAINS

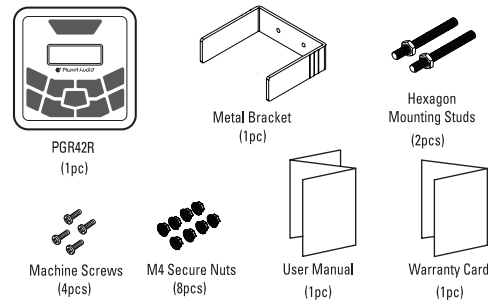

FCC COMPLIANCE STATEMENT

NOTE: This equipment has been tested and found to comply with the limits for a Class B digital device, pursuant to Part 15 of the FCC Rules. These limits are designed to provide reasonable protection against harmful interference in a residential installation. This equipment generates, uses and can radiate radio frequency energy and, if not installed and used in accordance with the instructions, may cause harmful interference to radio communications. However, there is no guarantee that interference will not occur in a particular installation. If this equipment does cause harmful interference to radio or television reception, which can be determined by turning the equipment off and on, the user is encouraged to try to correct the interference by one or more of the following measures:

- Relocate or reorient the receiving antenna.
- Increase the separation between the equipment and receiver.
- Connect the equipment into an outlet on a circuit different from that to which the receiver is connected.
- Consult the dealer or an experienced radio/TV technician for help.

!! WARNING !!
ADJUSTMENT OR ALTERATIONS OF THIS DEVICE MAY RESULT IN HAZARDOUS RADIATION EXPOSURE.

1 IMPORTANT SAFETY PRECAUTIONS

BE SURE TO OBSERVE THE FOLLOWING GUIDELINES:

- Do not turn up the volume so high that you can't hear what's around you.
- Use caution or temporarily discontinue use in potentially hazardous situations.
- Do not operate mobile video equipment while driving a motorized vehicle – safe driving and safety consideration of others should always be your highest priority.
- Set your volume control at a low setting, then slowly increase the sound until you can hear it comfortably without distortion, or ear discomfort.
- In the event you should notice smoke, strange noises or odor from this product, or any other abnormal signs, immediately turn off the power and consult your dealer or the nearest authorized **PLANET AUDIO Service Center**. Using this product in this condition may result in permanent damage to the system.

2 SUGGESTED MOUNTING METHODS

1 Make the mounting hole size as follows

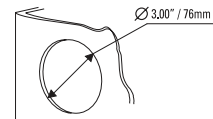

CAUTION!!
Using other mounting methods may void this warranty

2 Install studs mounts into rear of chassis

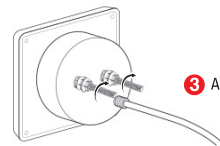

3 Adjust M4 nuts for the best mounting depth

4 Slip the unit through the hole cutout and into U-bracket

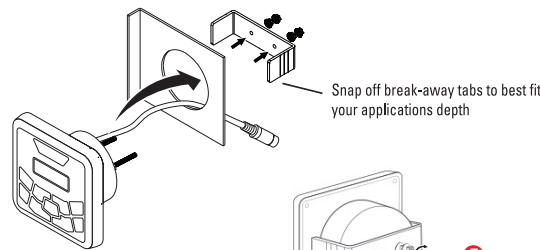

Snap off break-away tabs to best fit your applications depth

5 Firmly tighten remaining M4 nuts

6 Secure and waterproof the wiring

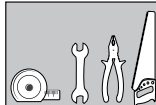

TOOLS NEEDED:
- Measuring Tape / Ruler
- Wrench and/or Pliers
- Hole Saw
- Crimp Tool

BEFORE YOU START

INSTALLATION PRECAUTIONS

Always consult with a professional installer

- Do not attempt to install or service this product by yourself. Installation or servicing of this product by persons without professional training and experience in electronic equipment and motorized vehicle accessories may be dangerous and could expose you to the risk of electric shock, injury or other hazards
- Refer any repairs to a qualified **PLANET AUDIO Service Center**
- The **PGR42R** should be wired directly to a vehicles battery
- When wiring directly to the vehicles battery, be sure to disconnect the batteries negative terminal wire before starting any wiring procedures, if extending the main power primary wire, it is suggested that an optional fuse and fuse holder (not included) with minimum rating of 20 Amperes be in-line with the positive battery terminal
- The ground cable length should be as short as possible, if extending from you battery, be sure to use a proper gauge rating for the length of the run, use only high quality copper primary type wire
- The **PGR42R** has a IPX6 weather resistant design, it should not be submerged in or under water under any circumstances
- Do not use abrasive cleaning materials on the lens or bezel
- Use only the installation parts provided with the **PGR42R**

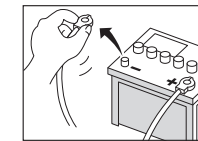

To avoid potential shorts in the electrical system, be sure to disconnect the (-) battery cable before installation. Use this unit with a 12-Volt battery and negative grounding only. Failure to do so may result in a fire or malfunction.



When replacing the fuse, be sure to only use a fuse of the rating specified on this product. To avoid short-circuiting, cover any disconnected leads with insulating tape. It is specially important to insulate any unused wires, which if left uncovered may cause a short circuit. When connecting other devices to this product, refer to the manual for the product to be connected. The black cable is ground, make sure to connect the ground wire first.

Ensure that the ground cable is properly connected to metal parts of the vehicles body frame or direct to the battery if your vehicle does not have a grounded chassis frame. The ground cable of this units power amp and a second powered system must be connected to the frame separately with different screws. If the screw for the ground wire loosens or falls out, it could result in fire or malfunction.

3 REMOTE CONTROL CONNECTIONS

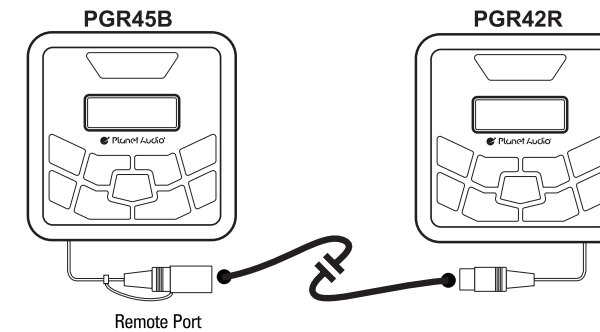

PGR25C - 25 ft Extension Cable (Not Included)
(Can be combined up to 100 ft)



TROUBLESHOOTING GUIDE

TROUBLE	CAUSE	SOLUTION
Unit will not turn on	The fuse is blown	Check / replace the fuse
	Ignition not engaged	Turn ignition to on position
No sound is heard	Blown speaker	Replace faulty speaker
	Volume is low / muted	Press the volume level up
	Device is paused or muted	Check your devices playing / volume status
Cannot pair Bluetooth	The Bluetooth function of the device is not enabled	Refer to the user manual of the device for how to enable the Bluetooth function
	The PGR45B BT memory is full	Follow how to reconnect a device in section E of the PGR45B User Manual
The audio quality is poor after connection with a Bluetooth enabled device	The Bluetooth reception is poor	Move the device closer to the audio system or remove any obstacle between the device and the systems antenna
	Power glitch or interference	Disconnect power for 10 seconds to reset (PGR45B)
Unit has become unresponsive	Low battery power	Charge battery, run the engine to recharge the battery
	Reset the main system	Follow steps in section B of the PGR45B Manual

TECHNICAL SUPPORT

1-805-751-4854
www.planetaudiousa.com/customer-support

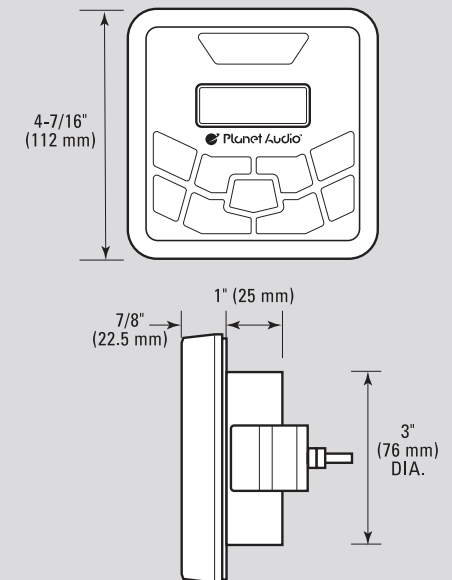

QUICK START GUIDE

A

GETTING STARTED

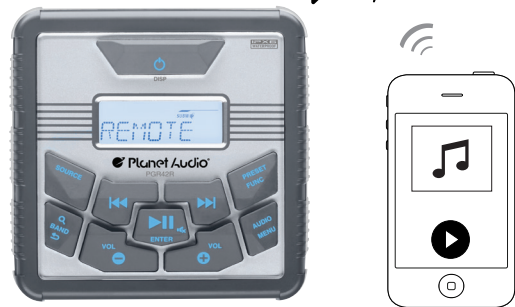

MUTE	◆ Short press to mute restore volume ◆ Turn the unit on, press and hold again to turn the unit off ◆ Press to pause, press again to resume playback
SEEK	◆ Tuner/Weather Band Mode: Press to enter into Manual Seek mode, press and hold to enter into Auto Seek mode ◆ Media Playback Mode: Press to Track Up/Down, press and hold for Fast/Forward/Rewind
SRC	Press to scroll and select available Source
PRESET FFn	Press to scroll and select Presets 1 ~ 6 Press and hold to enter into Tuner Function modes: A-STORE / M-STORE / LOCAL / AREA / RDS / AF / TA / PTY
VOLUME	Press + to decrease volume, press - to increase volume
BAND	◆ Tuner/Weather Band Mode: To change different band, press and hold to access Auto Store mode, the strongest stations of the selected band will be saved in preset channel automatically (FM1, FM2, AM1, WB1) ◆ Media Playback Mode: Press to access into search Folder/File music mode ◆ Returns to previous item
DISP ENTER	◆ Tuner Mode: Press to view RDS receiver information ◆ Media Playback: Press to view ID3 information
AUDIO	◆ Press to access into the Audio Menu mode for adjustments: EQ / XBASS / BASS / MIDDLE / TREBLE / BALANCE / FADER / READOUT / SUBW / SUBW LPF / SUBW LEVEL ◆ Press and hold to access into the System Menu: BT RECONNECT / BEEP ON/OFF / ABOUT / RESET

SOURCE MODES

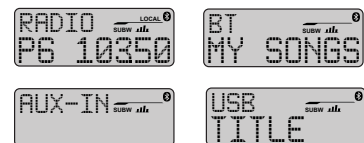

All rights reserved. No part of this publication may be reproduced, distributed, or transmitted in any form or by any means, including photocopying, recording, or other electronic or mechanical methods, without the prior written permission of PLANET AUDIO Inc.

B

TUNER SETUP

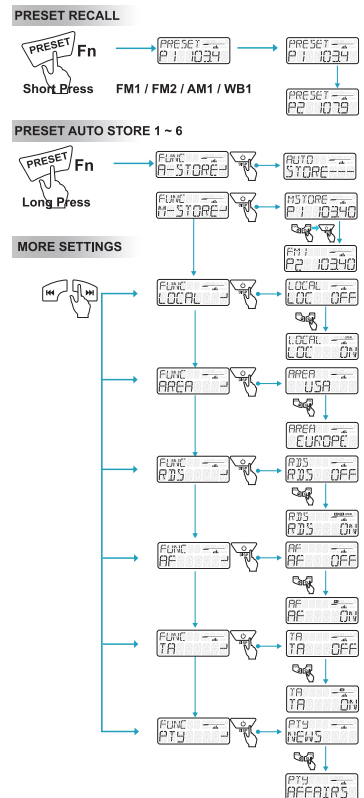

1. Long Press for FUNCTION options	2. Navigate Main System Tree	3. Press ENTER to select option	4. To select through FUNCTION options
Media Playback Mode			
Repeat	◆ ALL: to repeat all tracks on the storage media ◆ Song: the current track will be repeated ◆ Folder: repeats all tracks in the current folder		
Random On/Off	This function allows you to play track/songs from the current album, songs or artist in a random order		
Tuner Mode			
Auto Store	Press to access into A-STORE mode, the strongest stations of the selected band will be saved in FM 1 or FM 2, AM 1 BAND presets automatically		
Manual Store	When a desired radio station is set, press M-STORE to save it in the memory, you can store a total of 12 FM or 6 AM		
Local On/Off	◆ ON: only stations with strong signal can be broadcast ◆ OFF: Stations of both strong and weak signals can be broadcast		
Area	Select suitable country area for this unit: USA / EUROPE / ASIA / AUST		
RDS On/Off	Turn On or Off the RDS function		
AF On/Off	◆ ON: The unit will search for another station with stronger signal, but with the same program identification as the current station automatically ◆ OFF: Turn off AF function		
TA On/Off	◆ ON: When there is traffic announcement, unit will automatically switch to the tuner mode (regardless of the current mode) and begins to broadcast the announcement on traffic conditions. When the traffic announcement is over, unit will automatically return to the previous mode ◆ OFF: Traffic announcement does not cut in		
PTY	Once inside the PTY mode, press the get into program type item, and rotate encoder volume knob to selected category. ◆ Available Program Type: POP M; ROCK M; EASY M; LIGHT M; CLASSICS; OTHER M; JAZZ M; COUNTRY; NATION M; OLDIES M; FOLK M; A-TEST; ALARM; NEWS; AFFAIRS; INFO; SPORT; EDUCATE; DRAMA; CULTURE; SCIENCE; VARIED; WEATHER; FINANCE; CHILDREN; SOCIAL; RELIGION; PHONE IN; TRAVEL; LEISURE; DOCUMENT		

C

AUDIO and SYSTEM SETUP

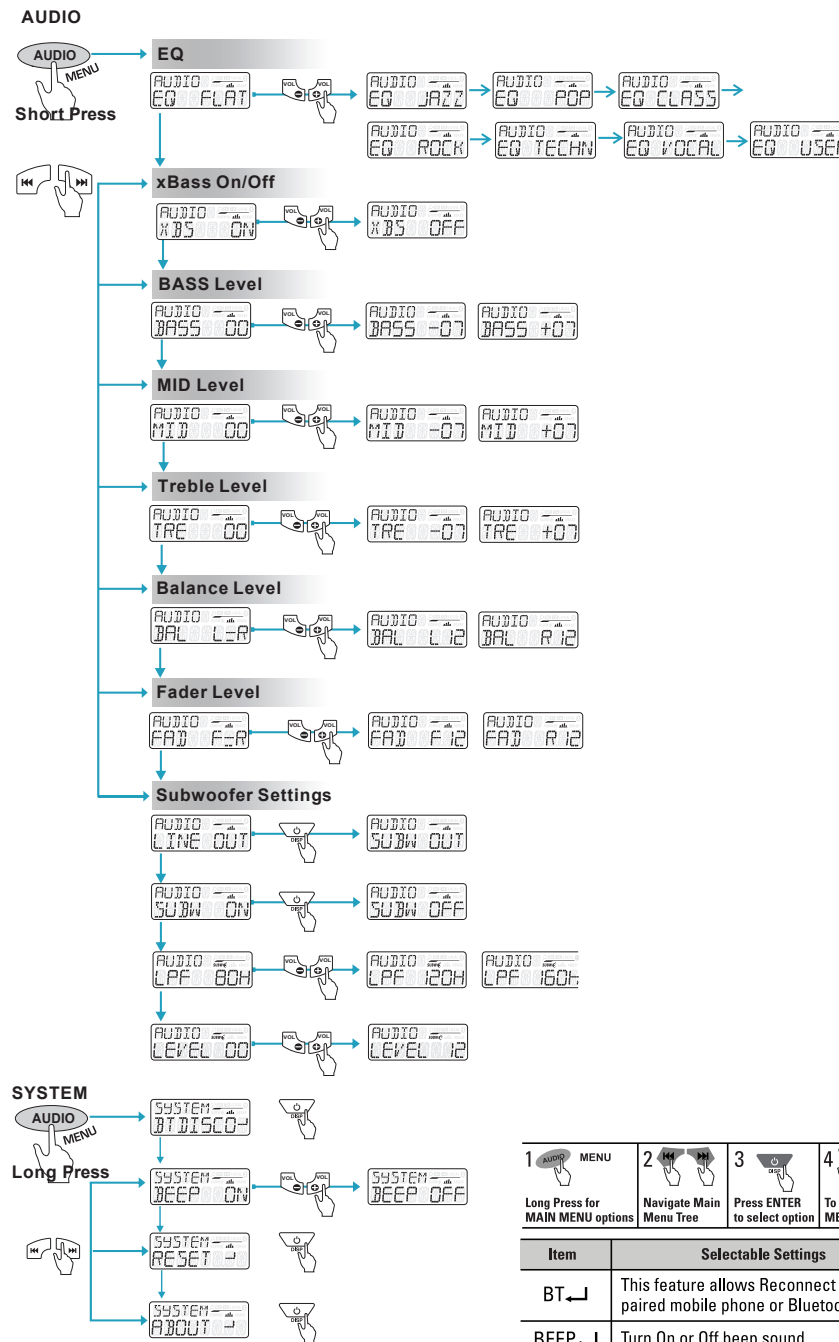

Tips: To avoid battery exhaustion be sure to run the vehicles engine while using this product. Using this product without running the engine can drain the battery.

D

RADIO OPERATION



- 1) Press the SRC button to select RADIO
- 2) Press **▶/||** to MUTE, press again to UNMUTE
- 3) To advance stations press **▶▶**
- 4) To skip previous stations press **◀◀**
- 5) Press the **DISP** button to display RADIO information
- 6) Press the PRESET button to recall PRESETS 1 ~ 6

E

BLUETOOTH OPERATION

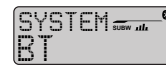

PAIRING & DISCOVERING A NEW BLUETOOTH CONNECTION
Note: The mobile device must be within 33ft (10m) of the PGR45B for Bluetooth to function properly.

- 1) Power on the PGR42R by pressing and holding down the Power button for 1 second, the Bluetooth ICON will start to flash signalling that the PGR45B is now ready for Bluetooth pairing.

NOTE: You have 2 minutes before you must restart this procedure over again.

- 2) Now that the PGR45B is in pairing mode:

ANDROID users:

- a. Go into the Settings Menu of your ANDROID device
- b. Enter the Bluetooth Menu and press SCAN
- c. "Boss Audio PGR45B" will now be display under AVAILABLE DEVICES
- d. If prompted, enter passcode: "0000"

iOS users:

- a. Go into the Settings Menu of your iOS device
- b. Enter the Bluetooth Menu
- c. "Planet Audio PGR45B" will now be displayed
- d. If prompted, enter passcode: "0000"

- 3) If the PGR45B is not seen, repeat the above steps to refresh the "Device List"
- 4) When the BT connection is successful you will see BT CONNECTED message on the PGR45B LCD display, you are now ready to stream music from your devices favorite media player to the PGR45B



RECONNECTION

- 1) Power on the PGR42R and your last paired device Bluetooth
- 2) The unit will now automatically be reconnected
- 3) If your device was previously paired with the PGR45B, but it wasn't the last paired device:
 - a. Ensure no other devices are currently paired
 - b. Press and hold MENU button to manually connect / reconnect to the PGR45B
- 4) If the device is out of range from the PGR45B, it will disconnect automatically:
- 5) The PGR45B will reconnect to the device once in range, a confirmation message will be displayed on the LCD

F

BLUETOOTH STREAMING MUSIC



- 1) Press the SRC button to select BT AUDIO
- 2) Press **▶/||** to start PLAY, press again to PAUSE
- 3) To skip songs or advance tracks press **▶▶**, press and hold to FAST FORWARD
- 4) To select the previous track press the button **◀◀**, press and hold to FAST REWIND
- 5) Press the **DISP** button to display song ID3 information

G

USB OPERATION



- 1) Press the SRC button to select USB
- 2) Press **▶/||** to start PLAY, press again to PAUSE
- 3) To skip songs or advance tracks press **▶▶**, press and hold to FAST FORWARD
- 4) To select the previous track press **◀◀**, press and hold to FAST REWIND
- 5) Press the **DISP** button to display song ID3 information

H

AUX-INPUT



- 1) Press the SRC button to select AUX IN
- 2) Press **▶/||** to MUTE, press again to UNMUTE

Tips: Ensure to adjust the level of your devices master volume to 75%